

# T-TRAK, "Trams, Trolleys, Trains, Two Tracks and Table Top"



This is the first T-TRAK module made in America. The base is inverted to have the track cross over a stream. A curved cloud skyboard is used.

**T-TRAK "N" Basic Standard**  
For Trolleys, small Steam and up to 4 axle engines.

**T-TRAK "N" Alternate Standard**  
For large Steam and 6 axle engines.

By Lee

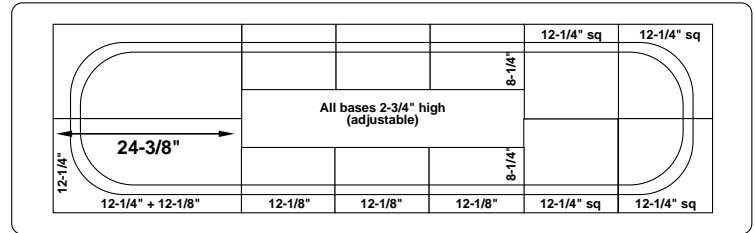

My T-TRAK #1 Demo layout on a 30" x 8' table.

Module, photo & text by Lee

Looking for a simple to build, easy to set up, plus great scenery possibilities, in a modular N Scale system? T-Trak may be just the thing. The modules are easy to transport, since they are about the size of a business letter page.

An entire layout could fit in most cars for a train show, depending on the scenery. A full operating layout could be set up in a short time on a folding table, no module legs are used.

For a club, if everyone brought one of these modules to a regular meeting, they could be quickly set up for running trains. New equipment could be tested. The modules could have scenery or could be all track and sidings.

The layout would easily be torn down again.

One or two club members can quickly set up a display layout at a service club meeting, hospital, children's ward, retirement village, nursing home, scouts, youth groups - endless opportunities.

At home, besides regular layouts of any size, they are ideal for shelf type layouts along with some special units for inside corners, yards and return loops. They are a nice way to display your trains in an artistic setting or for photo backdrops.

For quick running, one could start with 4 corners adding straight modules as desired. I saw Kato "roadbed" Unitrack for the first

time, in Japan and is available, internationally. This is similar to road bed track for buses that I worked with for many years, for the many NTRAK modules, that I have built. I saw the answer for the people that I have spoken to, at shows, who were interested in model railroading but could not build full modules, for various reasons. I created "T-TRAK" for Trains, in 2001 and named it, "T-TRAK, Trams, Trolleys, Trains, Two Track, Table Top"--accepted World-Wide. Since then, I have been expanding and sharing my ideas, for the benefit of T-TRAK modelers, in many scales and for the benefit of Model Railroading.

## Construction

### The T-TRAK "N" Basic Standard

### Straight Module

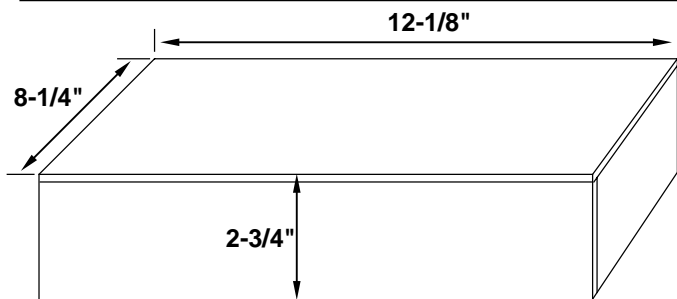

#### Standard T-TRAK Module Dimensions

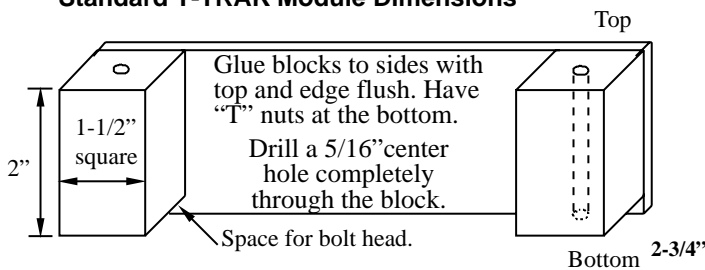

**Note:** If using a clear coat finish, a choice of construction is to cut the front piece 2-3/4" h and the top 12-1/8" x 8". No front plywood edge will show.

- 1/4" plywood: 1 ea. 12-1/8" x 8-1/4" top
- 1 ea. 12-1/8" x 2-1/2" front, back optional
- 2 ea. 8" x 2-1/2" ends. (Adjust length for back)
- 4 ea. 1-1/2 sq. x 2-1/8" lumber, glue blocks

Use a good wood glue.

(For thinner plywood, use smaller glue blocks at joints.)

Place these 2-3/4" h. wood T-TRAK modules right on a table, for fast, easy set-up, with other same construction T-TRAK modules. Use leveling bolts, only if needed. (Hint), try leveling table first. **Important Dimensions**

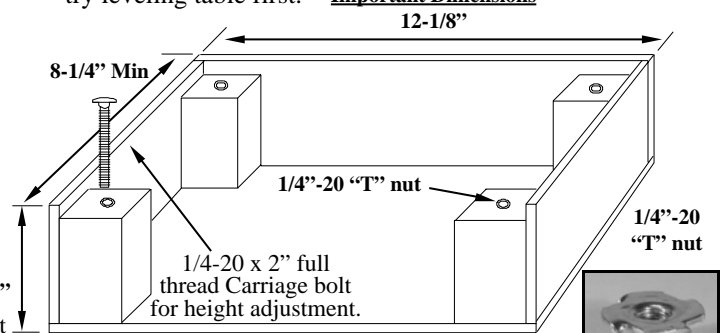

Glue front to sides - then glue top in place.

Check [www.T-TRAK.org](http://www.T-TRAK.org) for extensive material. Many Scales. [LEE@T-TRAK.org](mailto:LEE@T-TRAK.org) ©2001 Lee Monaco-FitzGerald

T-TRAK column in each issue of the NTRAK Newsletter.

T-TRAK Data sheet #1.9, May '07

This Data sheet may be copied for personal, non commercial use only.

# "Trams, Trolleys, Trains, Two Tracks and Table Top"

## TRACK

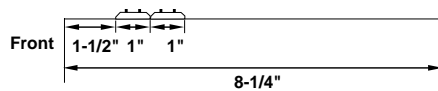
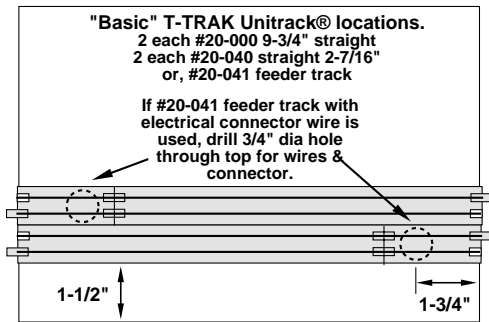

Suggested track is Kato Unitrack®, for positive locking rail joiners. The track is sized to fit exactly. The rail extends, at least, 1/32" from the edge.

Gluing suffices in most applications, especially if some scenic material is glued close to the roadbed of the track. Screws or nails can be used if preferred.

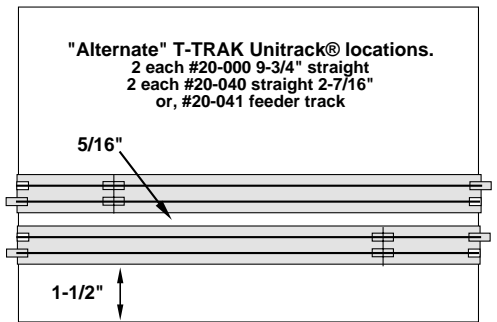

**Rerailer and Guide:** Besides aligning locomotive wheels on track, a Kato Rerailer has notches on the edge to help lay the double (33 mm) track and removing Unijoiners.

For Electrical Power: One module should have #20-041 feeder tracks which have Blue & White connector wires. Placing these short track pieces, as shown, will place the right blue wire on the front rail, front track

and the left blue wire on the back rail, back track. The polarity is then the same for everyone. This is the trouble-free standard for track power, to date. "BLUE to Outer Rails".

The holes for the wires are placed 1-3/4" in from the edge of the module to allow access for socket replacement and keep them free of the joining area. No measurable resistance was found up to a 30' layout of modules tested.

### Basic corner

For Trolleys, 4 axle engines and small steam

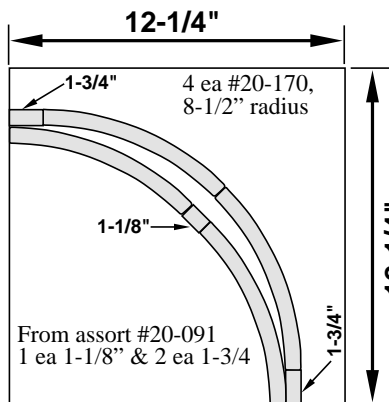

From assort #20-091  
 1 ea 1-1/8" & 2 ea 1-3/4"

Use 1/4" plywood. 1 ea 12-1/4" sq x 1/4",  
 2ea 12-1/4" x 2-1/2", 2ea 11-3/4" x 2-1/2"

**Track Option:** If you can cut track, Flextrack can be used with Kato track by

### T-TRAK "N" Corner Modules

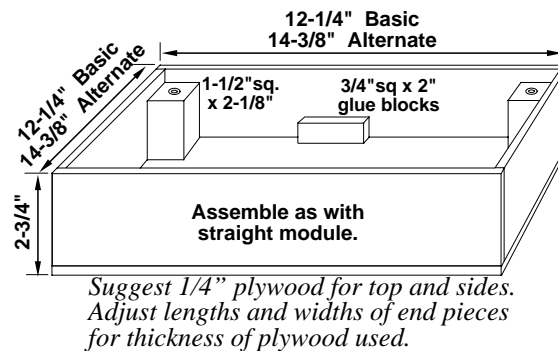

removing the Kato Unijoiner on one end of a small track section and substituting a regular joiner, which should fit well. The Unijoiner at the other end will still join modules together. Cork roadbed will raise the height of the flextrack to the Kato track height. The flextrack is helpful if you need to adjust easements on the curved corners. Many glues are strong or your preference may be using screws or nails with the mount-

### Alternate corner

For long cars, 6 axle engines and large steam.

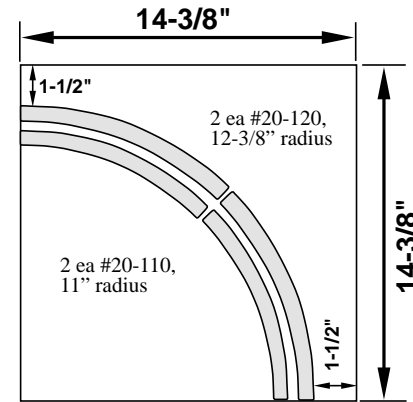

Use 1/4" plywood. 1 ea 14-3/8" sq x 1/4",  
 2ea 14-3/8" x 2-1/2", 2ea 13-7/8" x 2-1/2"

ing holes in the back of the track as a guide. Some modelers like to solder.

## NEW!! T-TRAK Module Kits

Straight Module and Corner Basic or Alternate Module Kits are now available.

Precision Cut, Baltic Birch, Original-International Specs, Easy Assembly GOT GLUE?

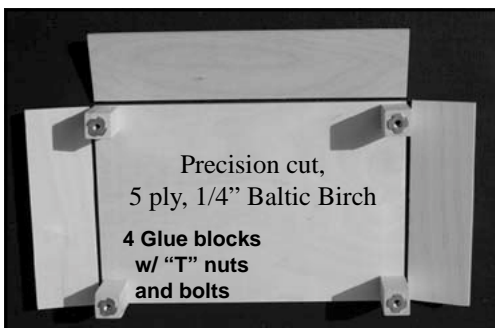

**CORNER KITS--** with corner blocks, extra 3/4" glue blocks, bolts and T-nuts inserted are included.

For other information and layouts, check the [www.T-TRAK.org](http://www.T-TRAK.org) website. Other applications will be addressed, as needed and researched.

T-TRAK Data Sheet #1.9, May, 2007

Kit	Kit	S&H
<b>Straight module-</b> (12-1/8"x8-1/4"x2-3/4"H)	\$9.75	\$4.70
Additional modules same order, each	\$9.25	\$2.75
<b>Basic corner</b> (12-1/4" square x 2-3/4"H)	\$13.40	\$7.25
Additional modules same order, each	\$12.75	\$3.00
<b>Alternate corner</b> (14-3/8" square x 2-3/4"H)	\$17.50	\$7.25
Additional modules same order, each	\$16.60	\$3.25

Order from: [www.ntrak.org](http://www.ntrak.org)  
 or NTRAK Order Dept.  
 15913 Brawner Dr, Montclair, VA 22025